



## Double Door - Divided Full & Half Depth Shelf Pantry Worksheet

Uses 4 "L" Bracket Installation On Base & Full Depth Shelves, Use 2 "RB" Bracket For Half Depth Shelves

### The full depth shelf type pantry will use:

4 "L" bracket method of installation for all shelves

### The half depth shelf type pantry will use:

4 "L" bracket method for the upper and lower base shelves

2 "RB" bracket method for all non-base shelves

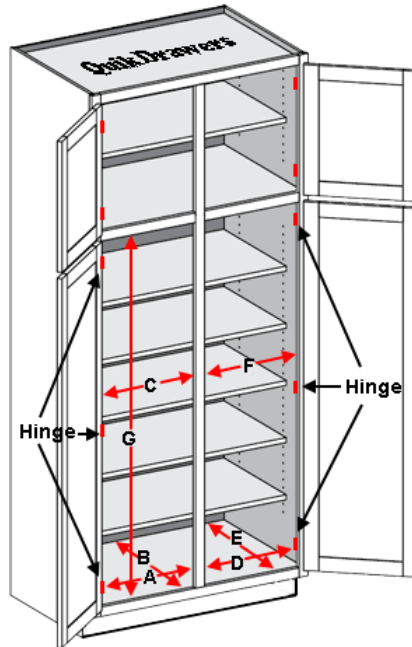

2 rear bracket installation for all non-base shelves

4 "L" bracket installation for all full depth shelves, including the upper and lower base shelves

A & D - From hinge to hinge (if present), otherwise from side of frame opening to opposite side of frame opening  
 B & E - From rear wall to inside of face frame  
 C & F - From side of frame opening to opposite side of frame opening, should be area clear of hinges  
 G - From base shelf to upper fixed shelf

- A,D** Record the measurement from hinge to opposite side of opening. If there is no hinge, then measure from side of opening to opposite side of opening.
- B,E** Record the measure from the rear wall to the inside edge of the front face frame
- C,F** Record the distance from one side of the opening to the opposite side of the opening. The upper shelf area should be clear of any hinges
- G** Record the height of the bottom opening

Cabinet #	"A"	"B"	"C"	"D"	"E"	"F"	"G"
_____	_____	_____	_____	_____	_____	_____	_____
_____	_____	_____	_____	_____	_____	_____	_____
_____	_____	_____	_____	_____	_____	_____	_____
_____	_____	_____	_____	_____	_____	_____	_____
_____	_____	_____	_____	_____	_____	_____	_____